



DORMA INTERIOR

PRIVE®
Framed Glass Wall Systems

Installation instructions

TABLE OF CONTENTS



Overview	
Versions	
Intended use	
Structure requirements and fittings	
Requirements for glass panel	
Safety instructions	
Maintenance, care and repair	
Disposal	3
Overall view	3
Pre-installation measurements tips	
Door frame alignment	
Daylight opening	5
INSTALLATION INSTRUCTIONS	
Install fixed panel wall post	6
Install sliding door jamb	7
Install angle bracket	8
Install header	9
Install glazing pocket	10
Install sill extrusion	11
Install sidelite glass	12
Install vertical post/l-post	13
Install vertical post covers	14
Instal Agile 150 roller carriers on monolithic glass ONLY	15
Install Agile 150 roller carriers on tempered laminated glass ONLY	16
Install sliding glass door panel	17
Install top filler	18
Adjusting end stop locations	19
Install floor guide	20
Adjustment door height	21
Adjusting the anti-jump	21
Install sliding door strike	22
Install track covers	23

TABLE OF CONTENTS



Overview

These instructions are for installation of the PRIVE® framed glass wall system for the following mounting and style versions:

1. Ceiling mount

Intended use

- for sliding doors in dry indoor areas only
- for manual slow opening and closing only

Structure requirements and fittings

- The substructure/wall must be able to bear permanent loads, be level and perpendicular (max. tolerance: 1/16" (2 mm) per meter). [1M = 39-3/8"]
- Fixings must be sufficiently dimensioned for the substructure/wall and weight of the door.

Requirements for glass panel

- Heat-soaked thermally tempered safety glass
- Clamping area must be level and uncoated (no self-cleaning coating!)

Safety instructions

- Installation requires two people
- Always wear protective clothing

Symbols used – Safety/Installation



Caution!

Mounting components must meet the requirements of substructure/wall and door weight. Please read the technical information for fittings.



Risk of breaking glass

When installing the door, support the door panel with a block of wood or similar object.



Information note

Always use silicone- and oil-free cleaners (e.g. acetone).



Closing edge

Maintenance, care, repair

- immediately replace damaged parts
- always use original DORMA parts
- use a damp cloth for occasional cleaning, especially the track

Disposal

Dispose in accordance with local, state and national regulations.

Overall view

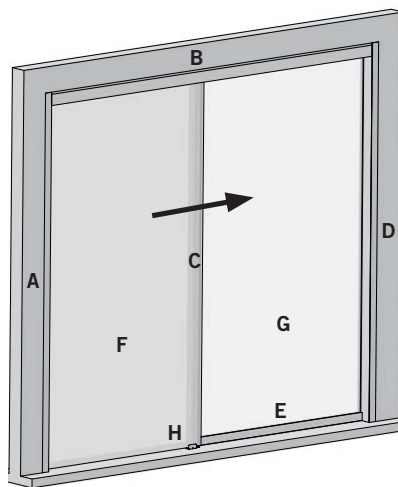

PRIVE®

- A. Sliding door jamb
- B. PRIVE® header assembly with Agile 150 roller carriers
- C. Vertical post/I-Post
- D. Fixed panel wall post
- E. Sill extrusion
- F. Sliding door panel
- G. Fixed door panel
- H. Floor guide

TABLE OF CONTENTS



Tempered laminate glass (TLG) and adhesive specifications

Required parts for laminate glass with Agile 150 (not included)	Color	Part Number	Quantity	Usage recommendation
3M™ Scotch-Weld™ Urethane Adhesive, DP 605 NS	off white	934.800	1 tube	1 tube per 4 roller carriers
3M™ Scotch-Weld™ EPX™ Plus II Applicator with 2:1 and 1:1 Plunger ²		934.801	1 applicator	
3M™ Scotch-Weld™ EPX™ Plus II Mixing Square Nozzle, 5.3mm ³	gold	934.805	(Pk of 4)	4 nozzles per 1 tube of adhesive
Laminated glass components		807.640	1 set	

Handling time frame	Function	Time
	Working life (time between application and clamping of carrier)	5 minutes @ 75°F
	Handling strength	20 minutes @ 73°F or more
	Full cure time (time until glass may be completely installed into door)	48 hours @ 73°F or more

NOTE: Door glass should not be installed until the full cure time as been reached (see chart above).

Important safety-related information for the mounting and use of DORMA glass hardware.

(Follow these instructions in addition to the mounting and operating instructions in order to avoid damage of product and damage to person or property.)

Important: This document is intended to inform users of safety-related information and the mounting and operation instructions.

General information

1. DORMA requires use of tempered glass.
2. DORMA glass hardware is not suitable for application in rooms where chemicals (e.g. chlorine) are used as indoor swimming pools, saunas or salt-water pools.
3. Never move sliding panels faster than walking speed and always stop the door manually before it reaches end position.

Mounting

1. Only properly qualified and specially trained staff is authorized to mount DORMA glass hardware.
2. Never use glass with conchoidal fractures and/or damaged edges.
3. Due to crushing hazards and possible injury caused by breakage of glass during mounting, corresponding protective clothing (especially gloves and protective goggles) is required.

4. Clean clamping area with alcohol-based standard commercial cleaning agent before mounting the glass hardware.
5. Never clamp metal glass fitting hardware directly to glass surface.
6. Never use clamping roller carriers on self-cleaning coatings.
7. When adjusting glass elements, always stick to the required clearance for the respective hardware. Adjust clearance so glass does not come in contact with any hard surfaces such as glass, metal or concrete.
8. Do not use excessive force when installing the glass (avoid over tightening screws).

Maintenance

Check glass hardware at regular intervals for proper positioning and smooth operation and correct adjustment. High traffic door systems require inspection by properly qualified staff (specialized companies or installation firms). Immediately replace damaged glass elements (no glass flaking and/or conchoidal fractures)! Only use suitable cleaning and care products to clean the surfaces.

² Scotch-Weld™ EPX™ Plus II Applicator with 2:1 and 1:1 Plunger is a trademark of 3M.

³ Scotch-Weld™ EPX™ Plus II Mixing Square Nozzle is a trademark of 3M.

Pre-Installation Measurements and Tips

Door frame alignment

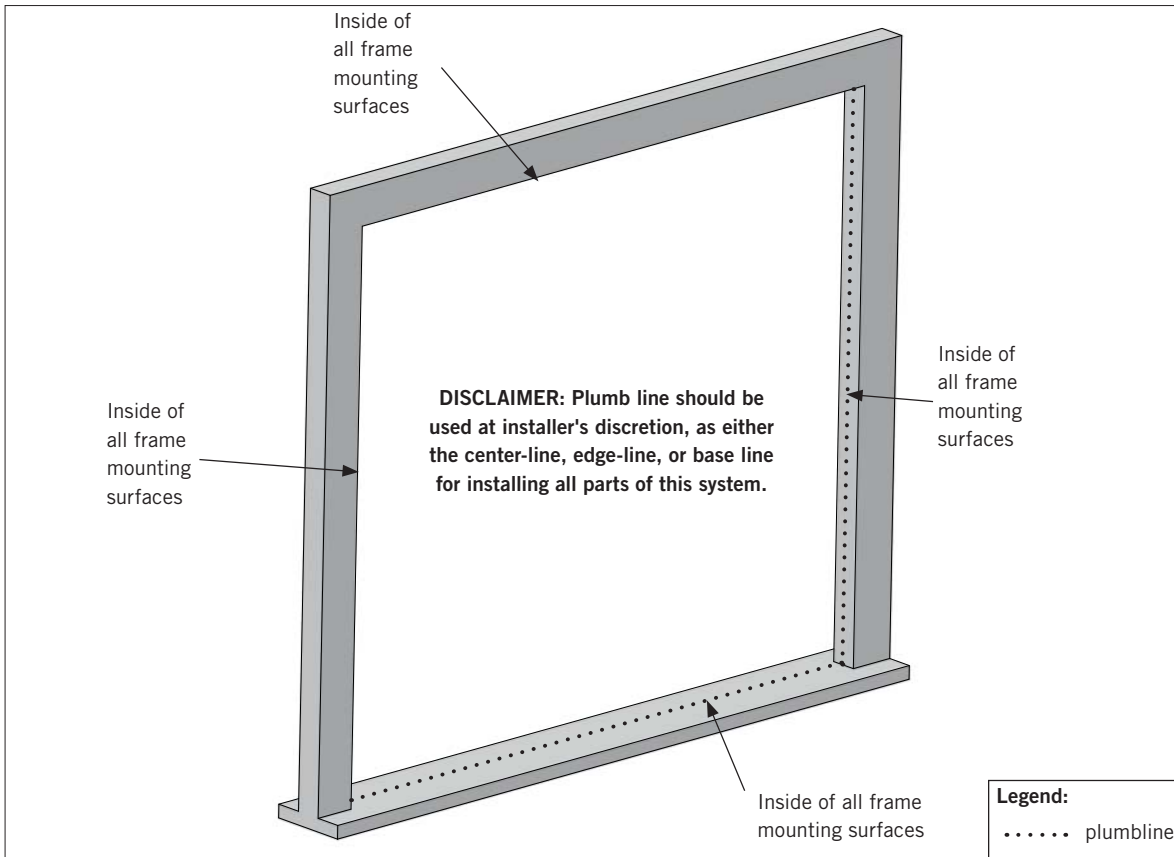

Mark a plumb line around the entire inside perimeter of the frame.

NOTE: Ensure walls, floor and ceiling mounting surfaces are plumb and level.

Daylight opening

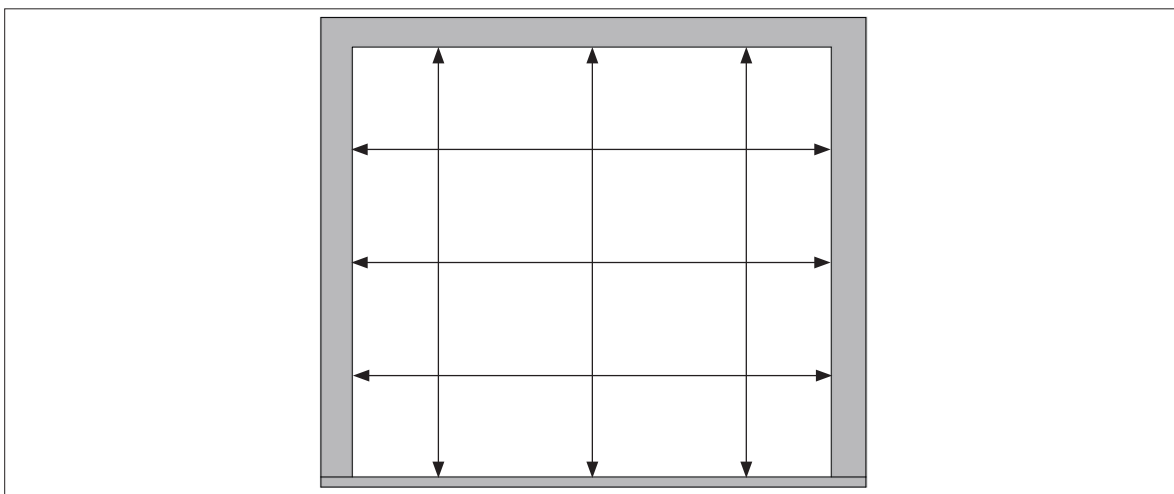

1.1 Measure your daylight opening.

INSTALLATION INSTRUCTIONS

Install fixed panel wall post

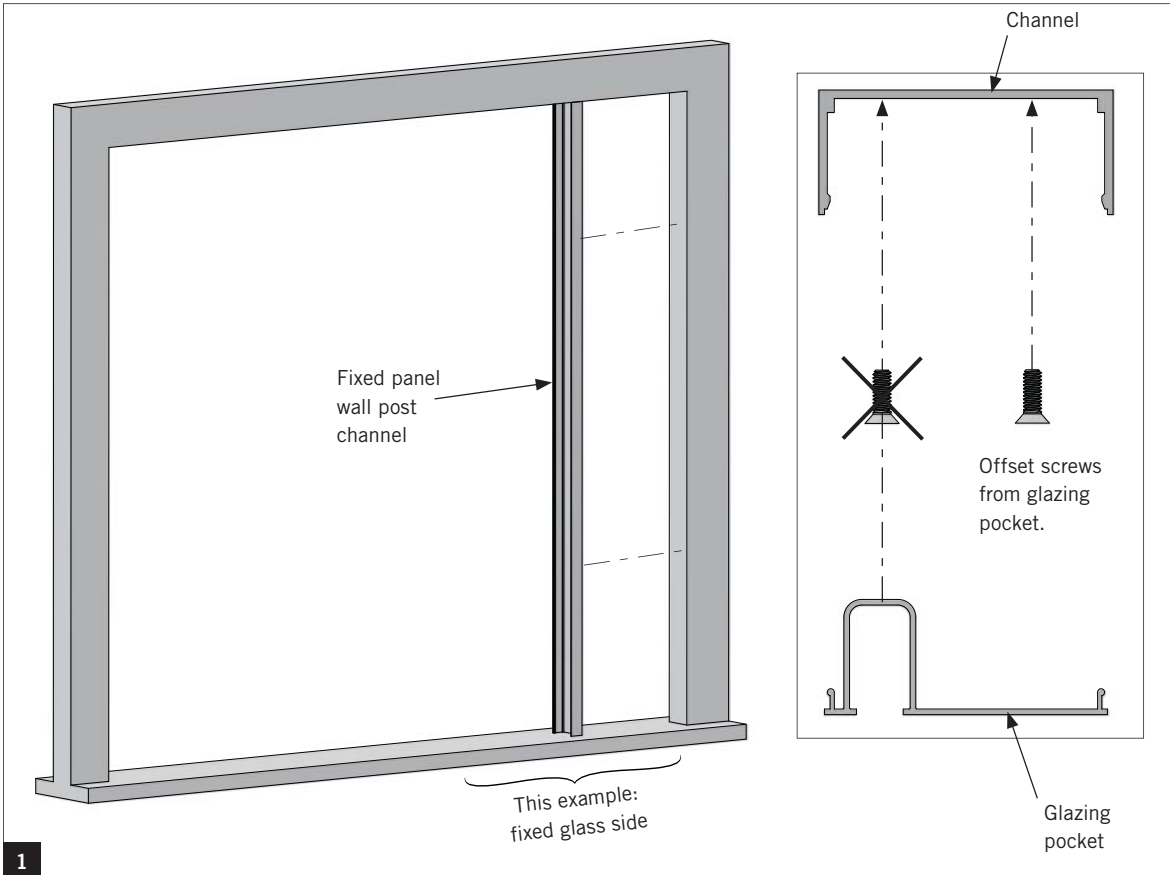

⚠ Holes are not pre-drilled in fixed panel wall post.

- 1.1 Disassemble post parts.
- 1.2 Measure and cut channel at full height.
- 1.3 Pre-drill holes.
- 1.4 Align channel with plumb line.
- 1.5 Secure channel to frame.

NOTE: Offset screws from glazing pocket.

NOTE: Ensure channel is plumb and properly oriented.

Install sliding door jamb

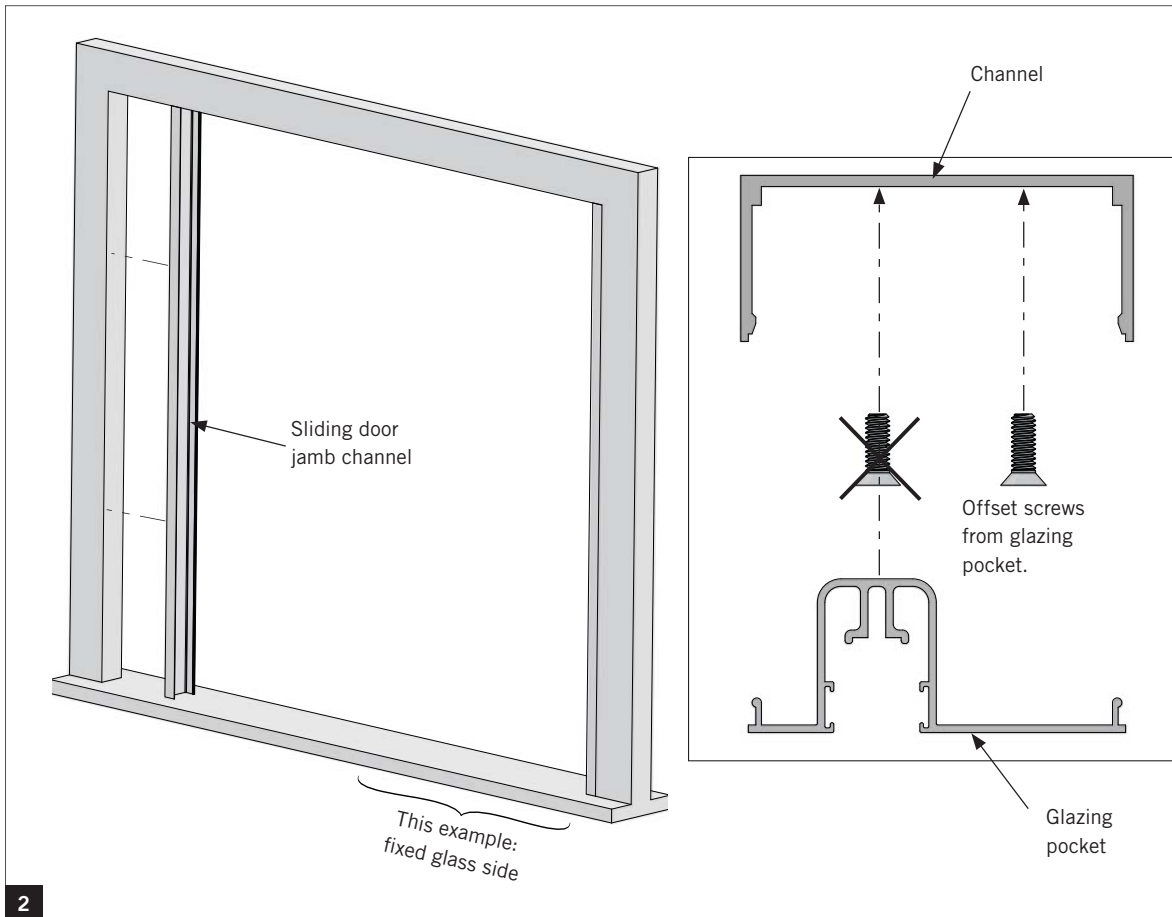

2

⚠ Holes are not pre-drilled in sliding door jamb.

- 2.1 Disassemble sliding jamb parts.
- 2.2 Measure and cut channel at full height.
- 2.3 Prill-drill holes.
- 2.4 Align channel with plumb line.
- 2.5 Secure channel to frame.

NOTE: Offset screws from glazing pocket.

NOTE: Ensure channel is plumb and properly oriented.

Install angle bracket

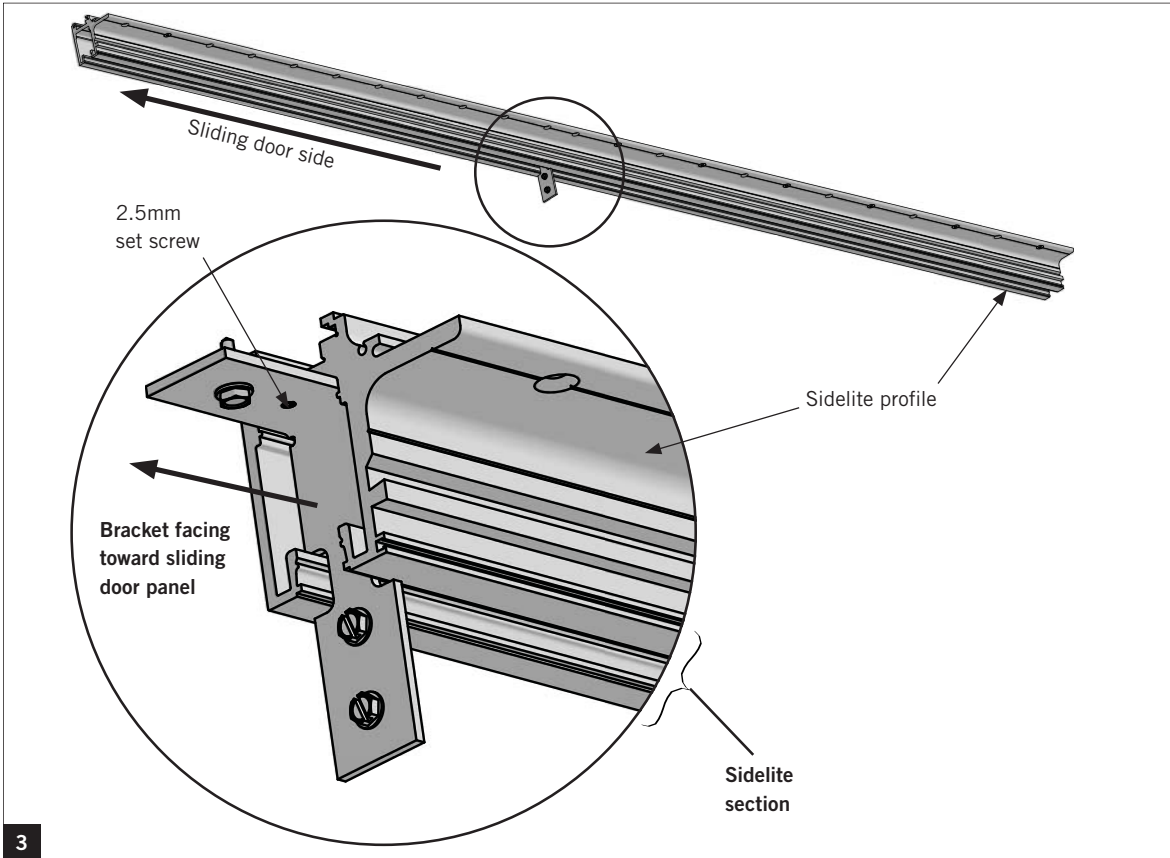

3.1 Disassemble header assembly.

3.1 Remove all screws.

3.2 Measure and cut 3-piece header.

- Length =
[dist. betw. *sliding door jamb* & *fixed wall post*] - 1/16"

3.3 Slide angle bracket into sidelite section of sidelite profile.

NOTE: Orient as shown above.

3.4 To temporarily secure, gently tighten 2.5mm set screw.
DO NOT FULLY TIGHTEN.

Install header

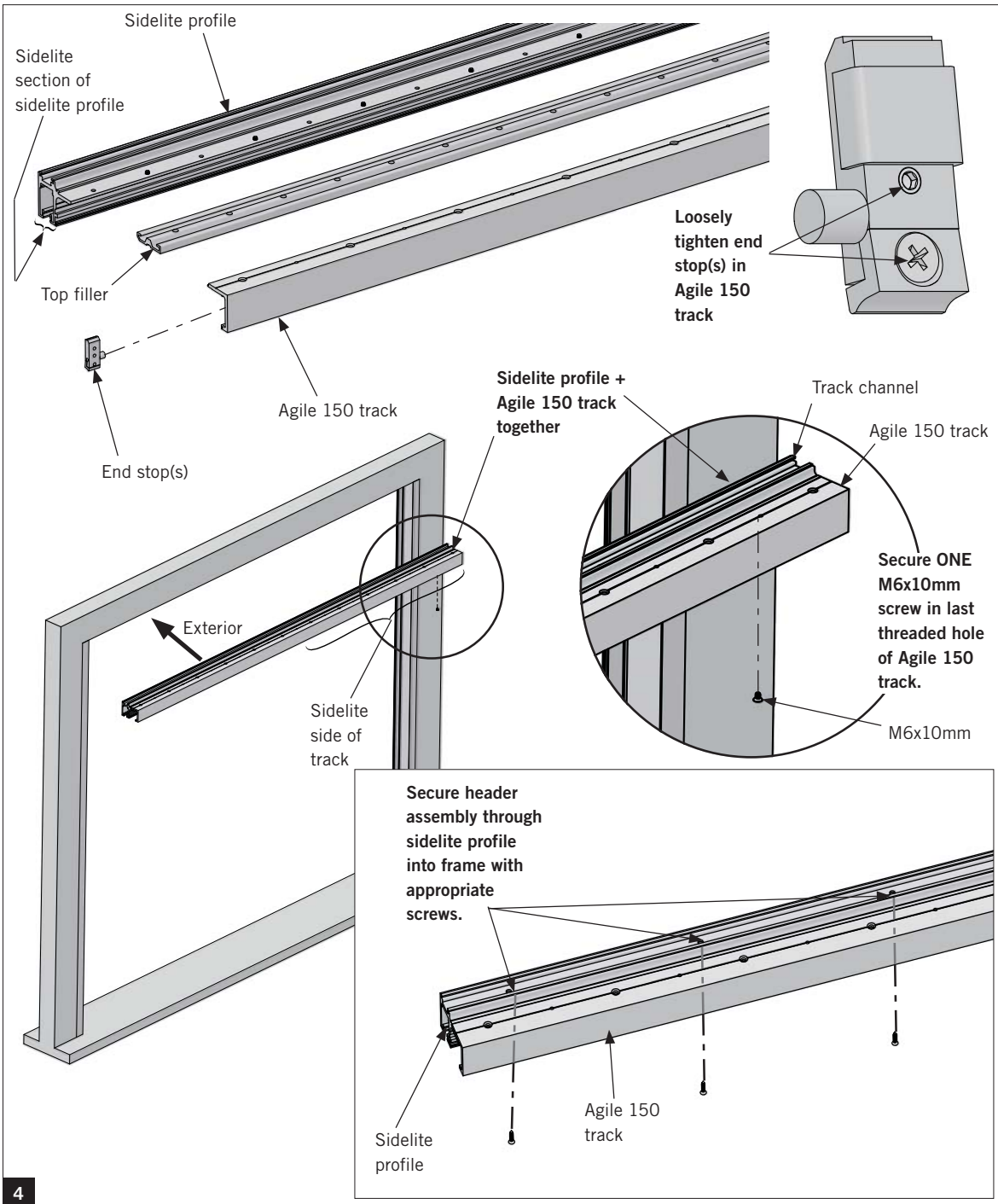

4

- 4.1 Remove top filler piece. Set aside.
- 4.2 Insert end stops into each end of Agile 150 track. Loosely tighten.
- 4.3 Orient header with sidelite section of sidelite profile towards exterior of opening.
- 4.4 Secure **sidelite profile and Agile 150 track (simultaneously)** to frame.
 - Secure with 10-32 machine screws or #10 wood screws, provided, through sidelite profile.
- 4.5 Secure ONE M6x10mm machine screw into **last threaded hole** in sidelite end of Agile 150 track only (for temporary holding).

Install glazing pockets

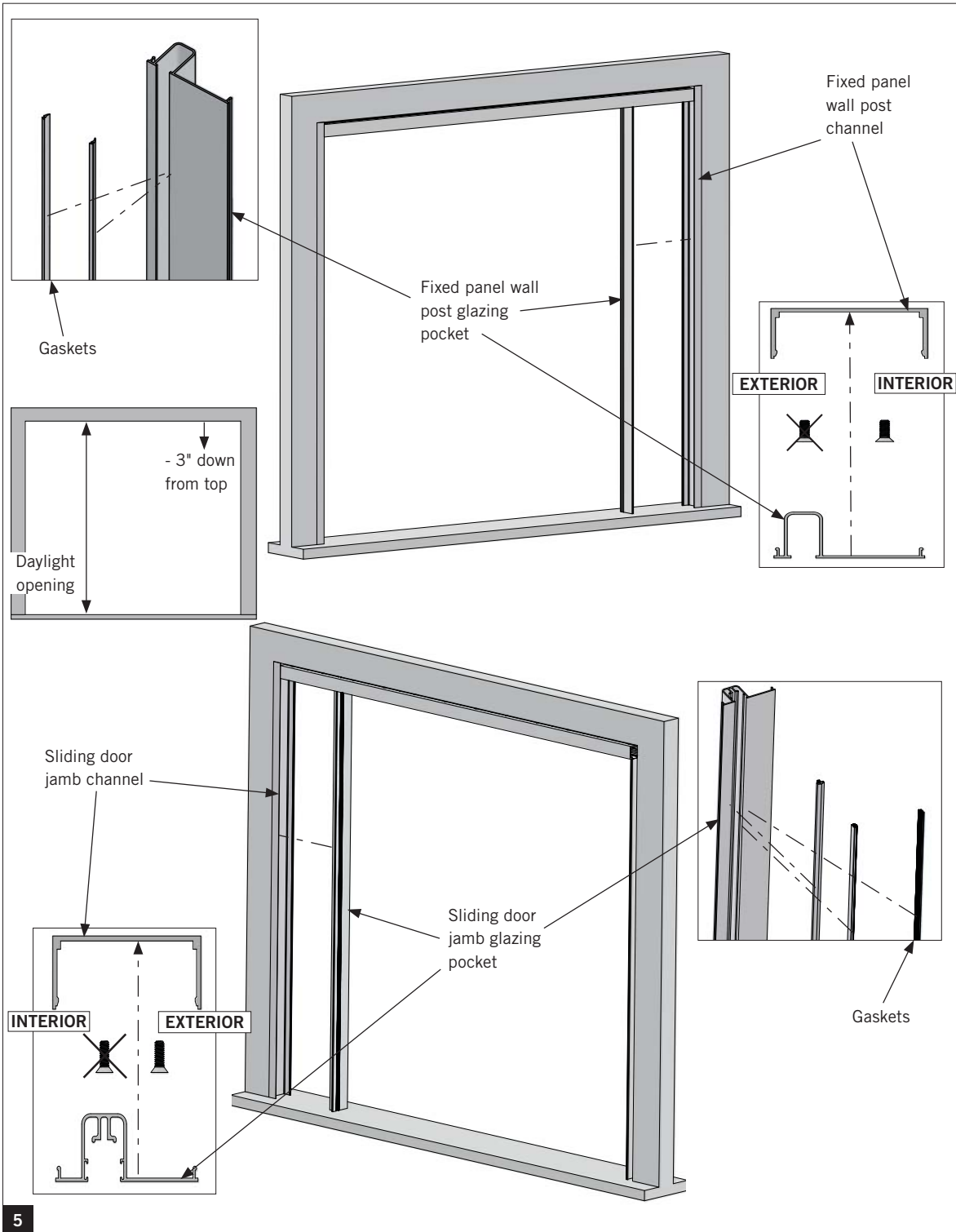

5

5.1 Cut glazing pockets and gaskets to fit between header and floor.

- Glazing pocket length = [daylight opening - 3"]

5.2 Install gaskets.

5.3 Snap glazing pockets into channels.

- Fixed panel wall post glazing pocket
- Sliding door jamb glazing pocket

Install sill extrusion

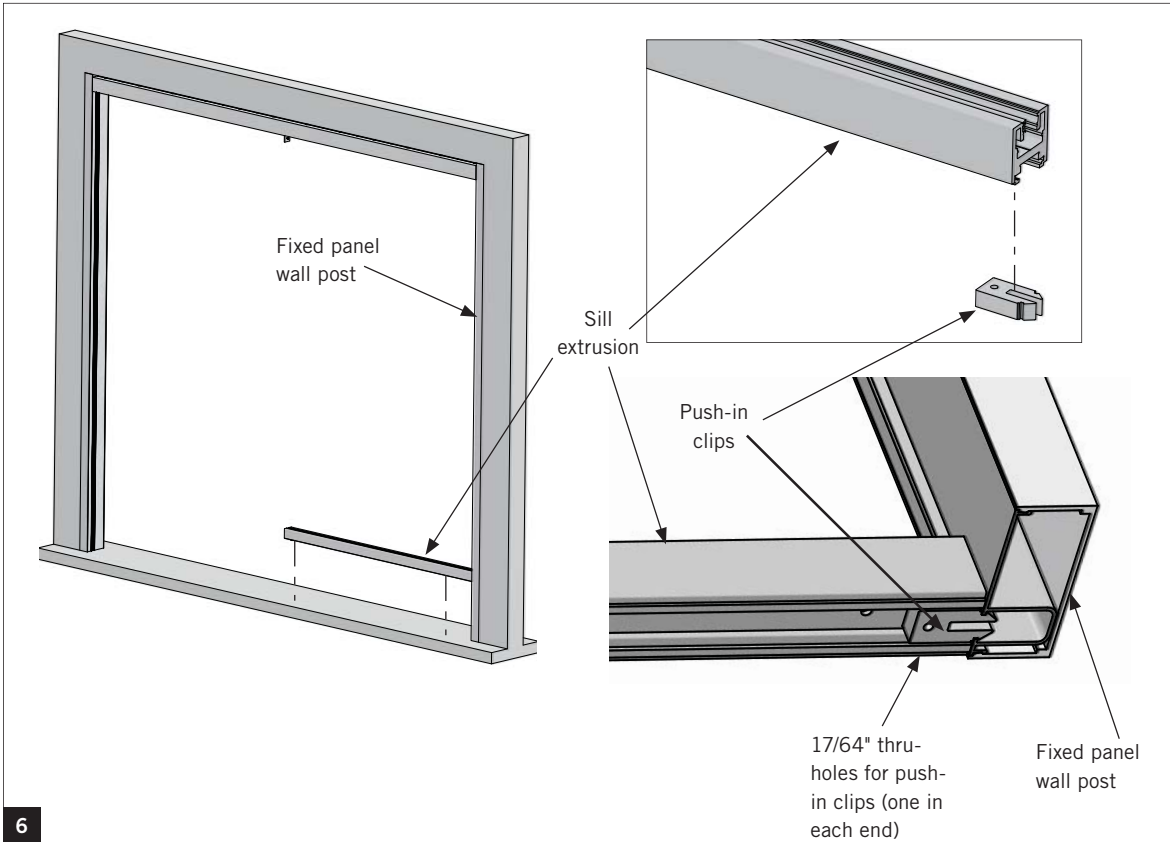

6

- | | |
|---|--|
| <p>6.1 Cut bottom sill extrusion and gaskets to length.</p> <ul style="list-style-type: none"> ▪ Length = clear opening - finished door opening - 3.5" <p>6.2 Drill and countersink one 17/64" thru-hole into both ends of sill extrusion for push-in clips.</p> <ul style="list-style-type: none"> ▪ Use included drill guide. | <p>6.3 Secure push-in clips to both ends of sill extrusion.</p> <ul style="list-style-type: none"> ▪ Use flat head screws provided. <p>6.4 Snap sill extrusion into fixed panel wall post.</p> <p>6.5 Align with bottom plumb line.</p> <p>6.6 Secure to floor with flat head screws.</p> |
|---|--|

Install sidelite glass

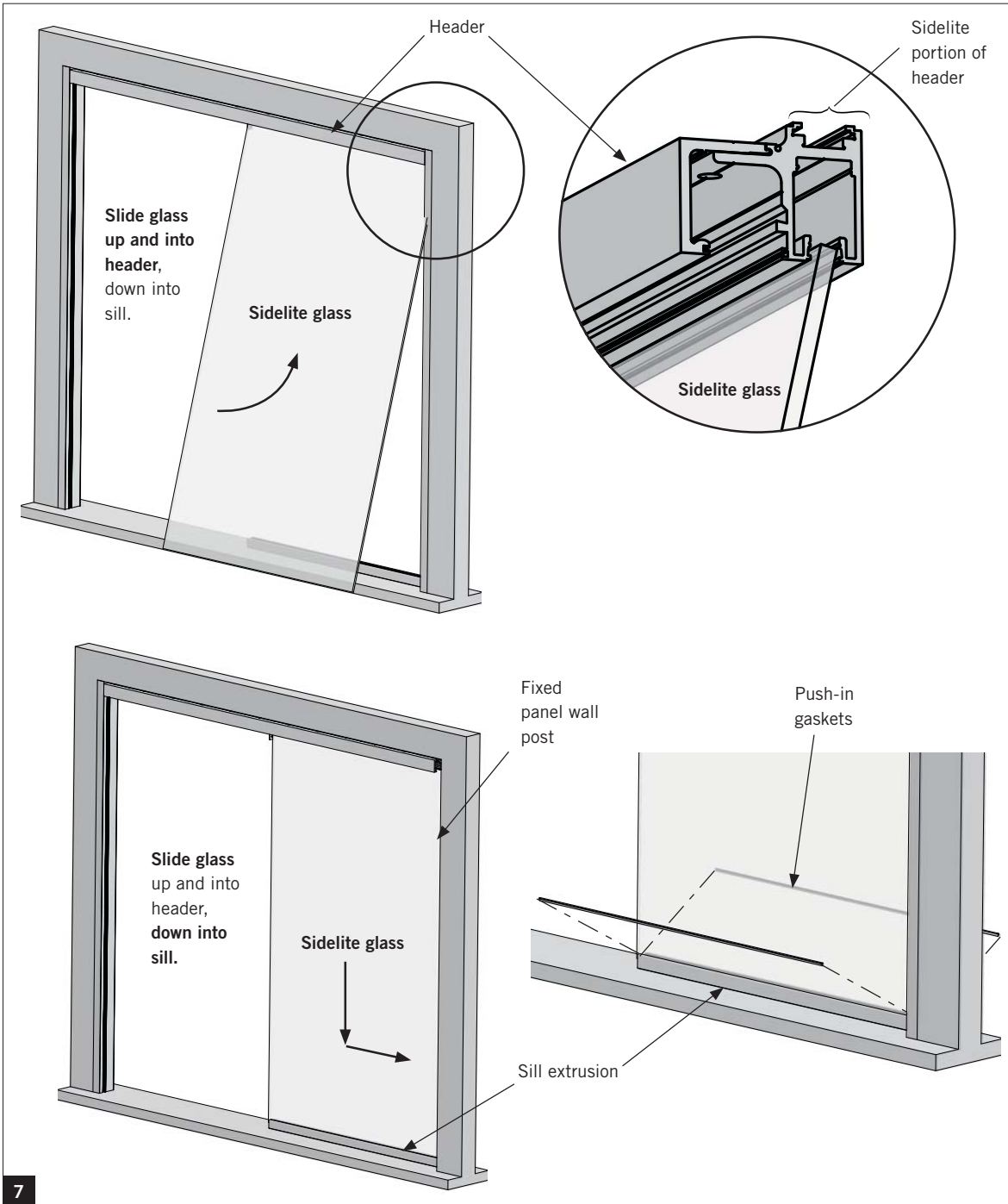

7.1 Place setting blocks into sill extrusion.

- Orient 2-1/2" off each end of sill.

7.2 Lift sidelite glass up and into sidelite portion of header and down into sill.

7.3 Slide into fixed panel wall post.

7.4 Install push-in gaskets into sill.

Install vertical post/I-post

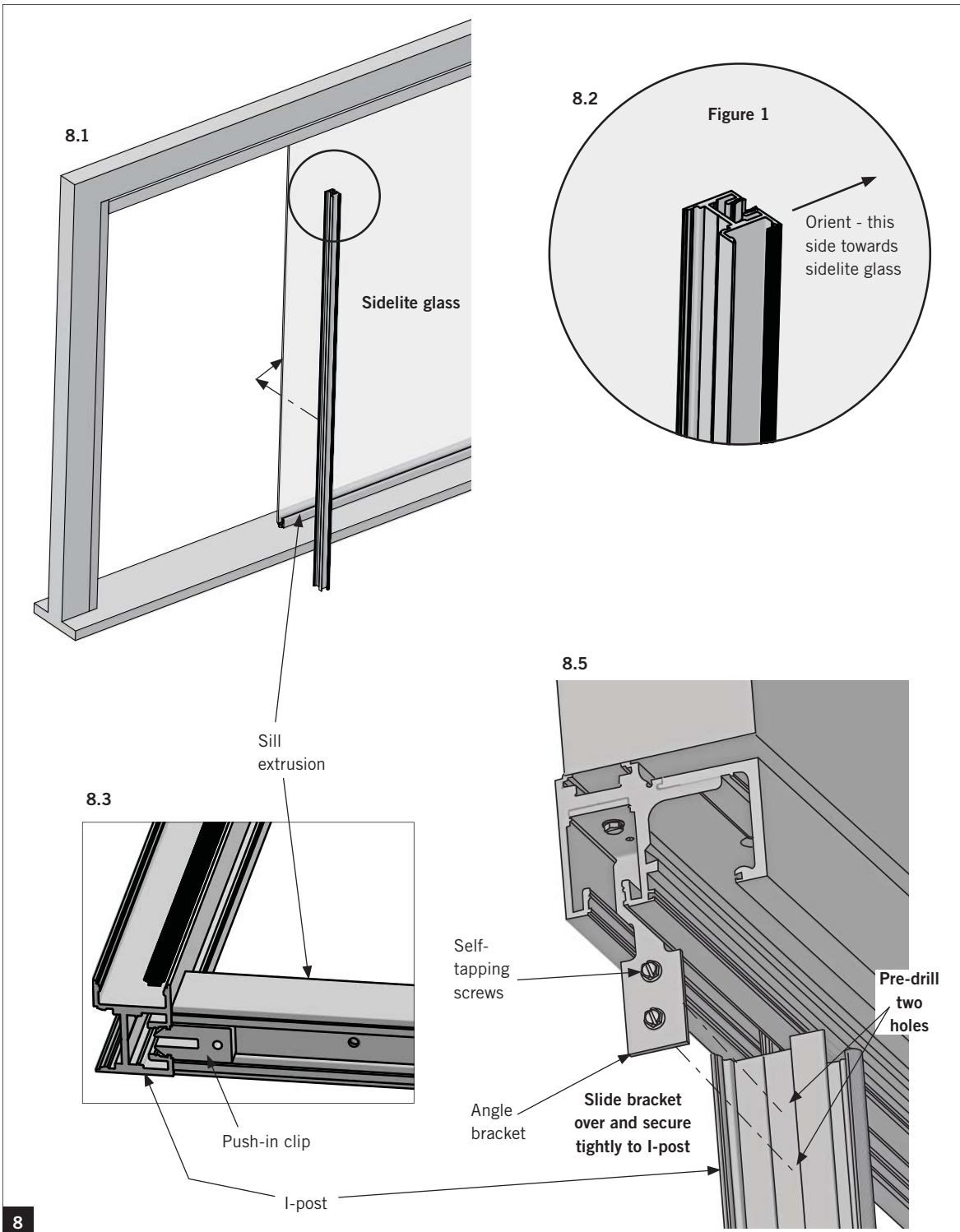

8.1 Measure and cut I-post assembly to fit between header and floor.

- I-post length = [daylight opening - 3"]

8.2 Pre-drill two holes with provided drilling guide.

8.3 Orient I-post properly. See Figure 1 above.

8.4 Snap bottom of post into push-in clip in sill extrusion.

8.5 Ensure post is plumb.

8.6 Slide angle bracket over and secure tightly to I-post.

- Use self-tapping screws provided.

Install vertical post/I-post covers

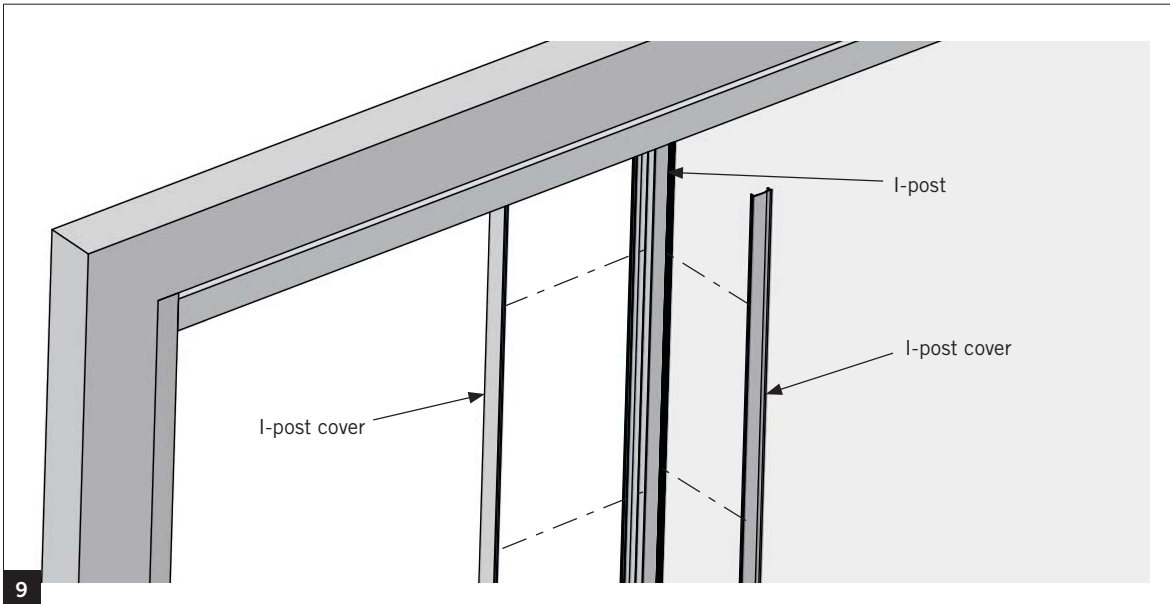

- 9.1 Snap I-post covers into place.
- One on interior side of opening.
 - One on sliding door side of opening.

Install Agile 150 roller carriers: on tempered monolithic glass ONLY

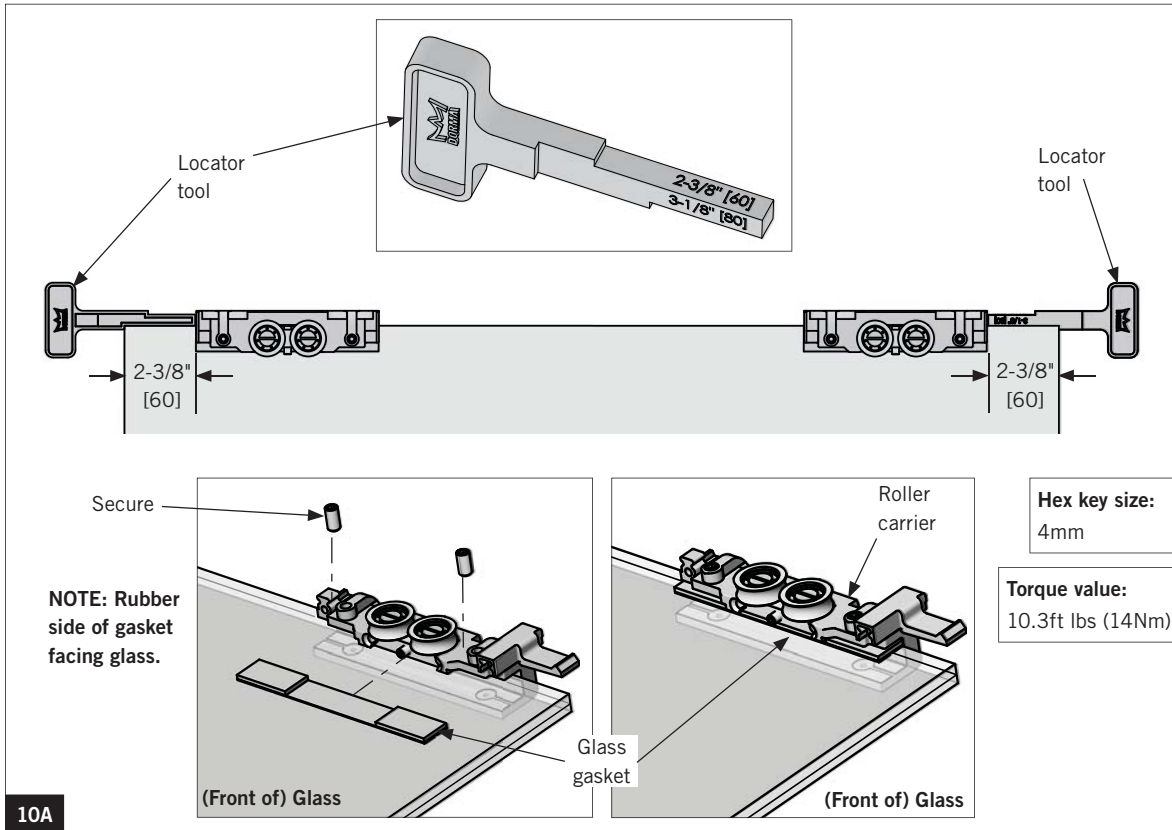

10A

NOTE: FULLY CLEAN SURFACE OF GLASS WITH AN ALCOHOL-BASED MILD GLASS AND SURFACE CLEANER. ENSURE NO DEBRIS IS ON THE GASKET. A CARRIER LOCATING TOOL IS ALSO AVAILABLE.

- 10A.1 Slide roller carriers onto glass.
- 10A.2 Slide glass gasket and metal shim between glass and roller carrier.
- 10A.3 Secure roller carriers to glass.
 - Use locator tool to position carriers correctly.
 - Use appropriate-size hex key at 10.3 ft lbs (14 Nm) of force.

NOTE: Orient shim with gasket side facing the glass.

Install Agile 150 roller carriers: on tempered laminated glass ONLY

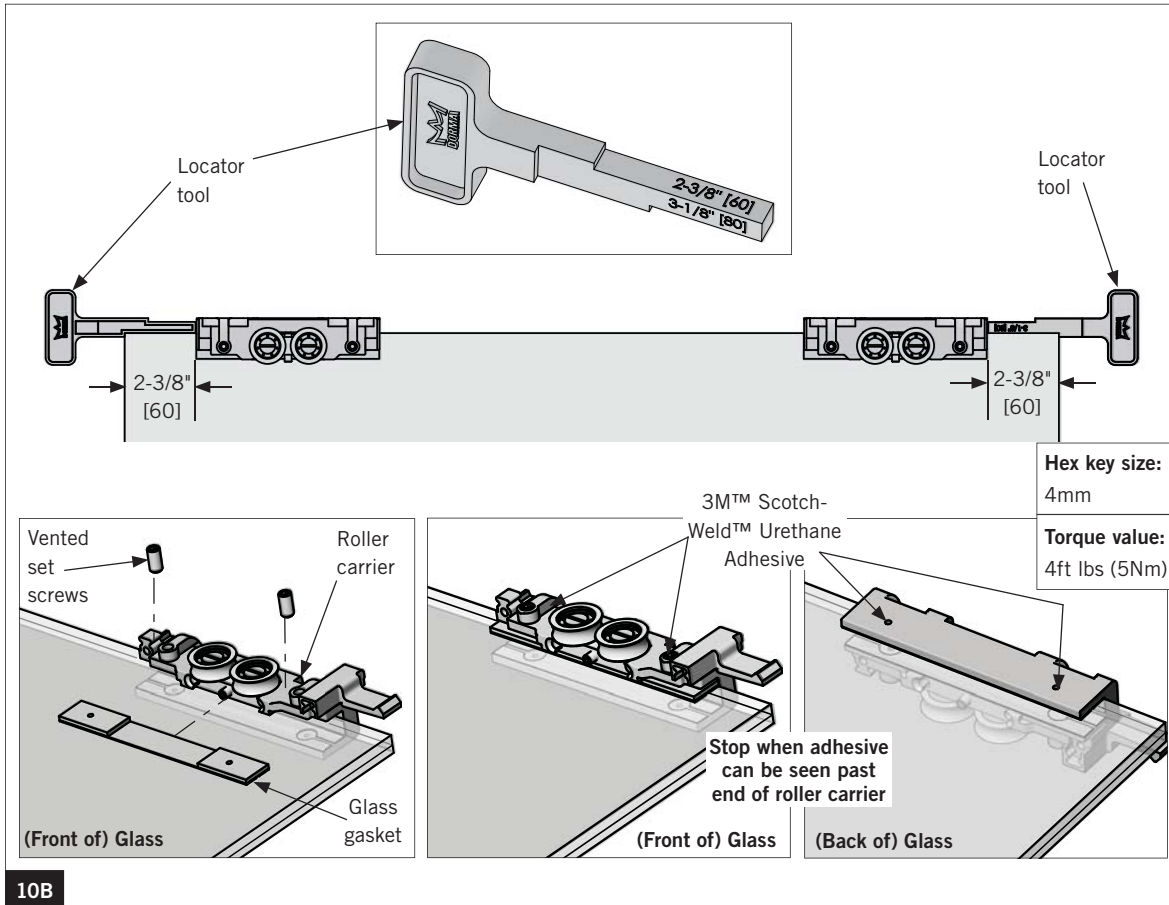

10B

NOTE: THE RECOMMENDED ADHESIVE'S SET-UP TIME IS 20 MINUTES FOR THE DUO-PAK CARTRIDGES.

NOTE: FULLY CLEAN SURFACE OF GLASS WITH AN ALCOHOL-BASED MILD GLASS AND SURFACE CLEANER. ENSURE NO DEBRIS IS ON THE GASKET. A CARRIER LOCATING TOOL IS ALSO AVAILABLE.

- 10B.1 Slide roller carriers onto glass.
 - 10B.2 Slide laminated glass gasket and metal shim between glass and roller carrier.
- NOTE: Orient shim with gasket side facing the glass.**
- 10B.3 Use locator tool to position carriers correctly.
 - 10B.4 Tighten vented set screws.
 - Use a torque wrench with 4 ft-lbs (5Nm).

- 10B.5 Apply adhesive.
- NOTE: Onto scrap material, first dispense approximately 12" of 3M™ Scotch-Weld™ Urethane Adhesive prior to application to prevent mixing errors and ensure optimal hardening.**

- Dispense adhesive into vented set screws on front and back of carrier.
- ⚠ Stop application when adhesive can be seen past edge of roller carrier.**

⚠ DO NOT WIPE EXCESS ADHESIVE from glass surface. Allow adhesive to dry and scrape off glass surface with a beveled-edge chisel or putty knife.

NOTE: Keep glass flat during curing process.

NOTE: See chart in Specifications section for appropriate curing time.

Install sliding glass door panel

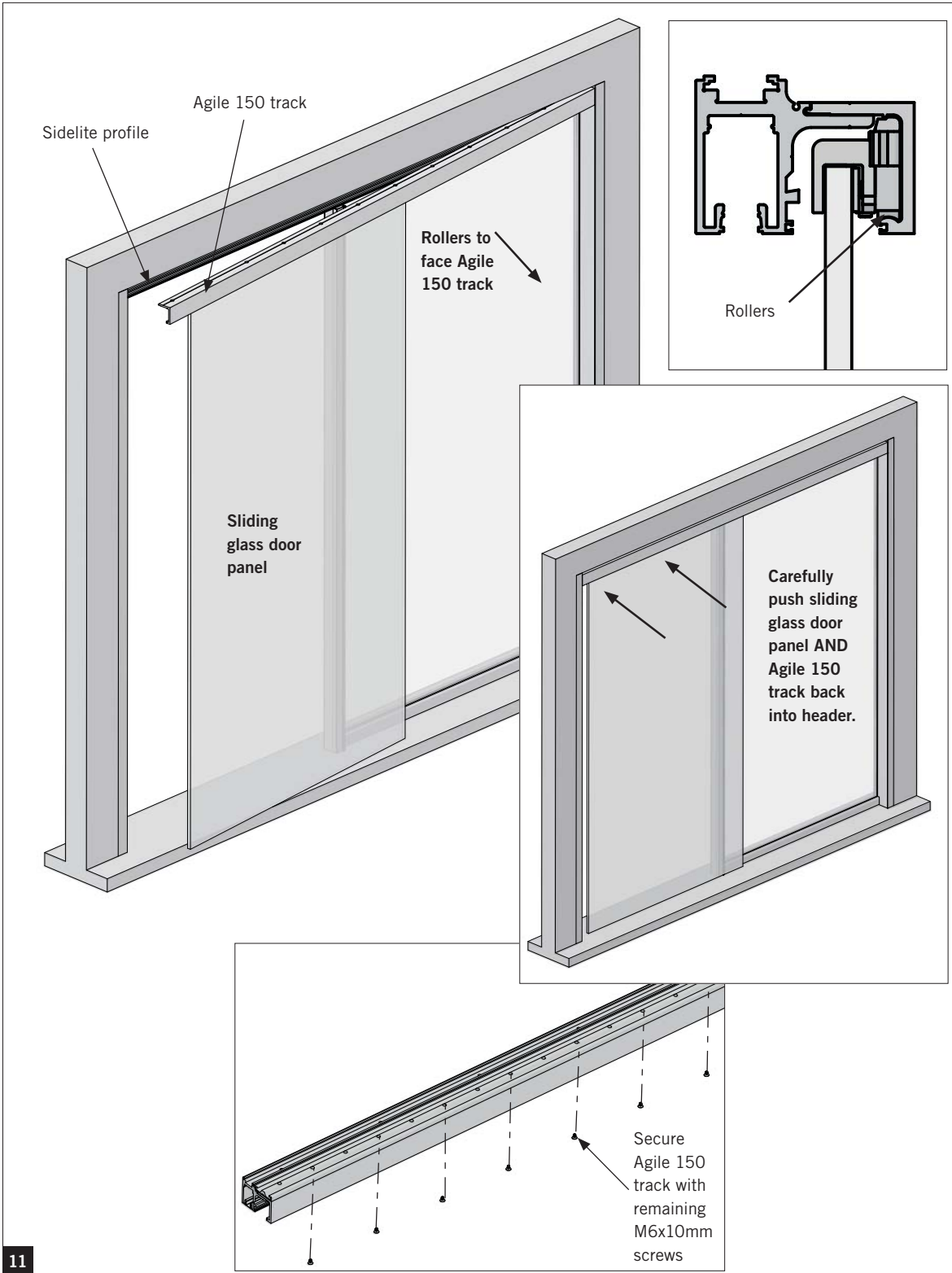

11

- 11.1 Pivot Agile 150 track portion away from sidelite profile.
- 11.2 Set door rollers onto track, **supporting weight with glass clamps until track is rotated into place and secured with remaining fasteners.**

NOTE: Rollers facing against Agile 150 track.

Install top filler

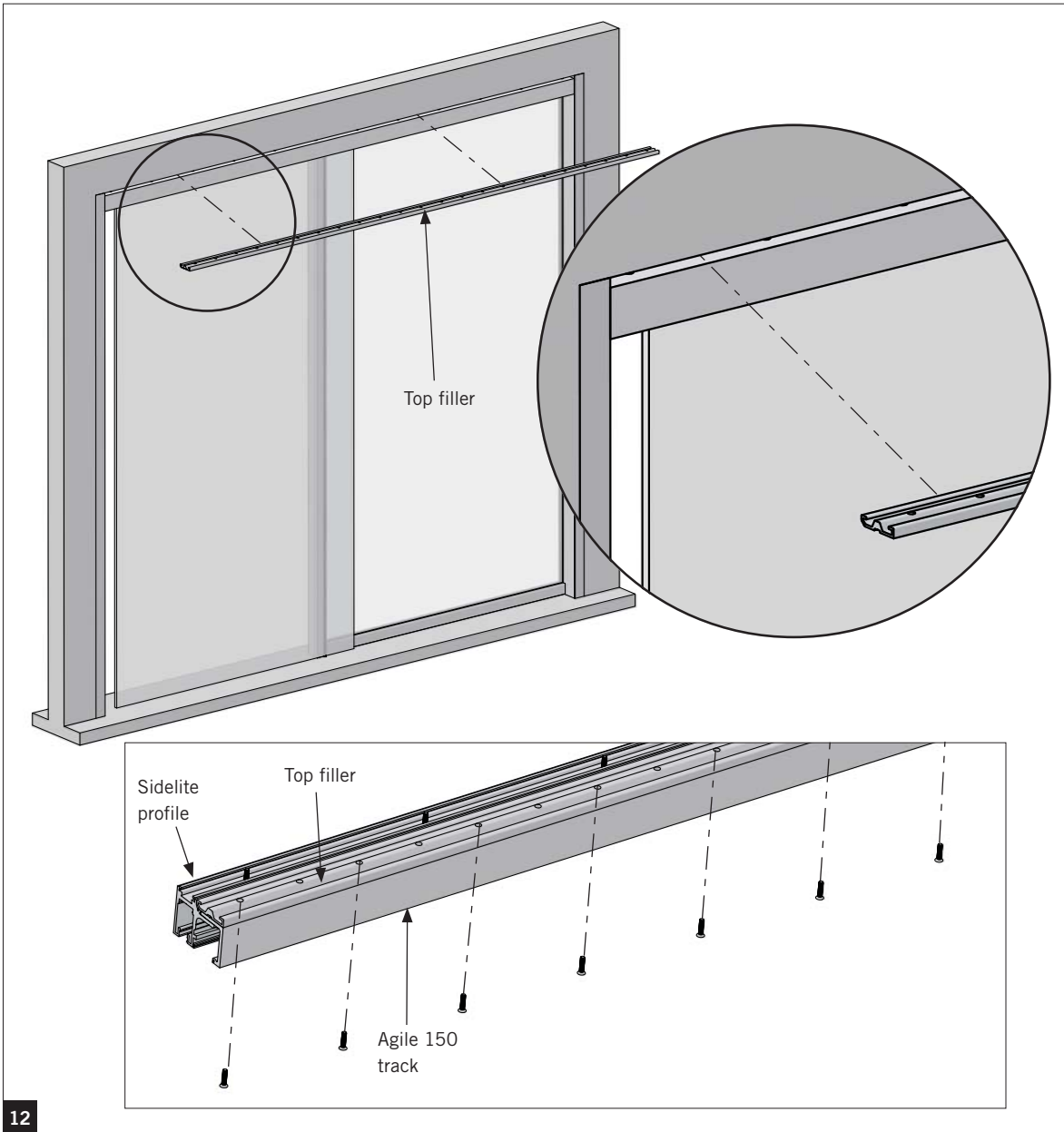

12

12.1 Slide top filler into gap above sidelite profile.

12.2 Secure Agile 150 track through sidelite profile with #10 wood screws into the threaded holes.

Adjusting end stop locations

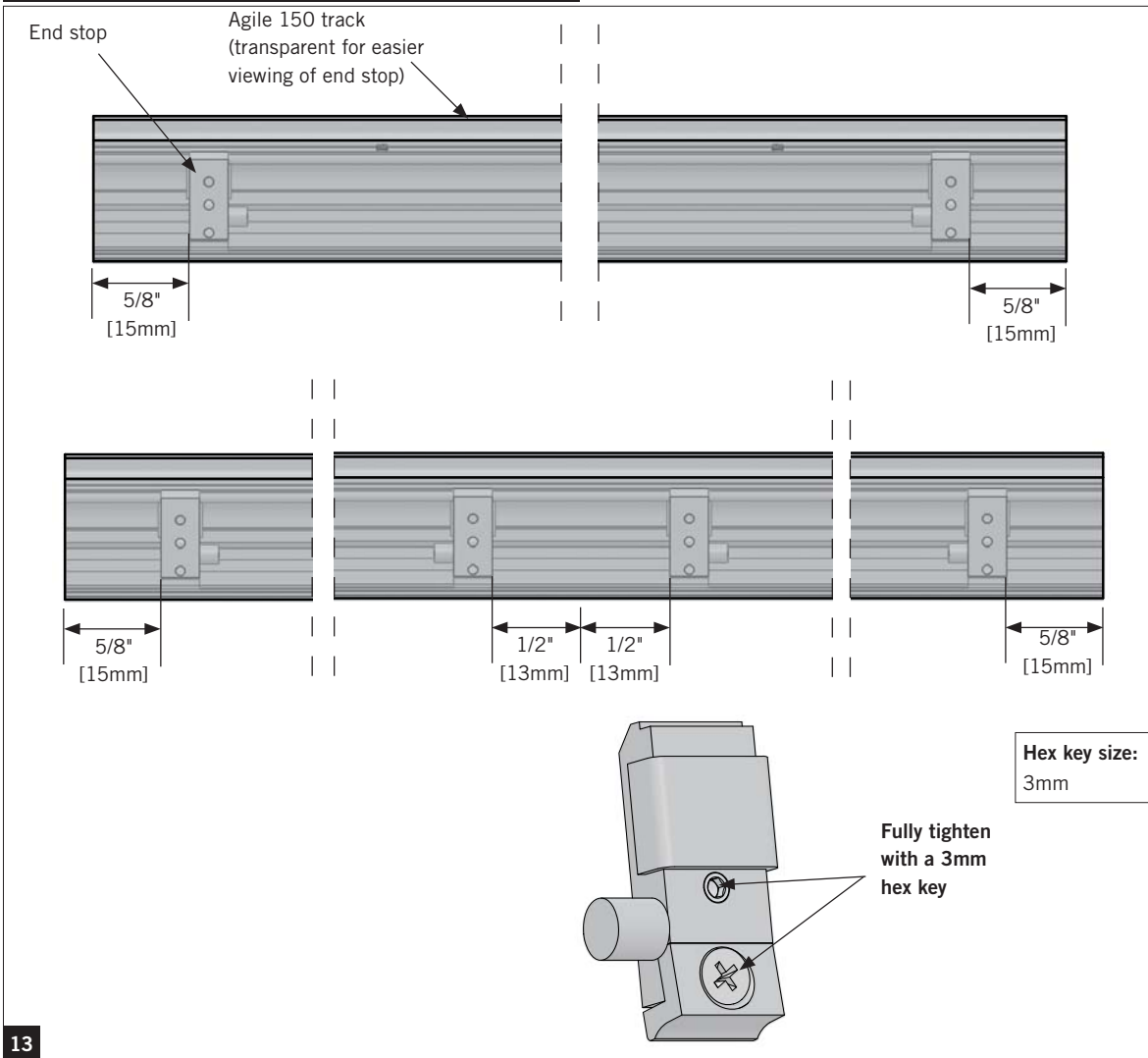

13

13.1 Slide end stop to desired location in track.

13.2 Use minimum distances as shown above.

13.3 Secure end stop in track using appropriate size hex key.

Install floor guide

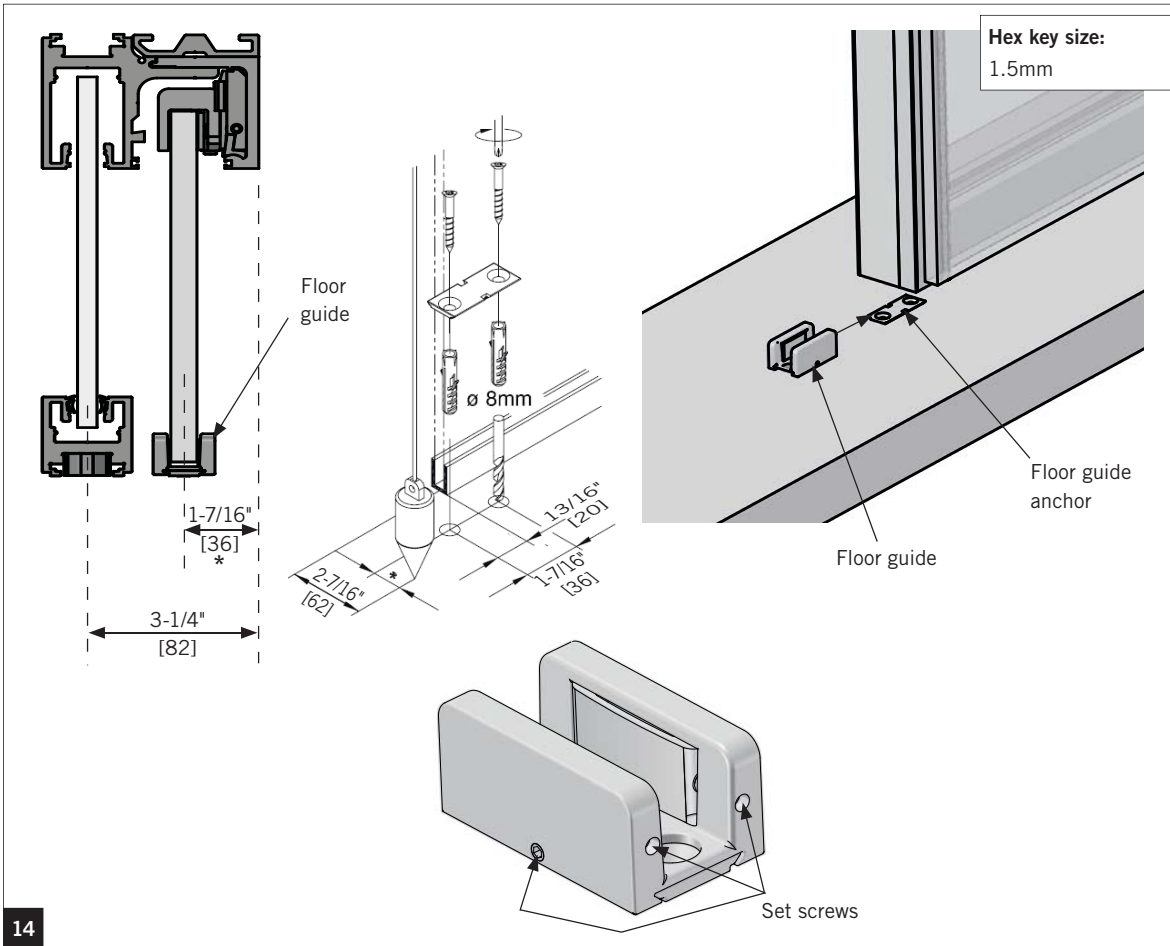

14

14.1 Mark appropriate floor guide measurements.

14.2 Pre-drill into mounting surface using a 5/16" drill bit.

14.3 Secure floor guide anchor with included fasteners.

14.4 Ensure glass is plumb and level.

14.5 Slide floor guide over anchor and tighten set screws.

Adjustment door height

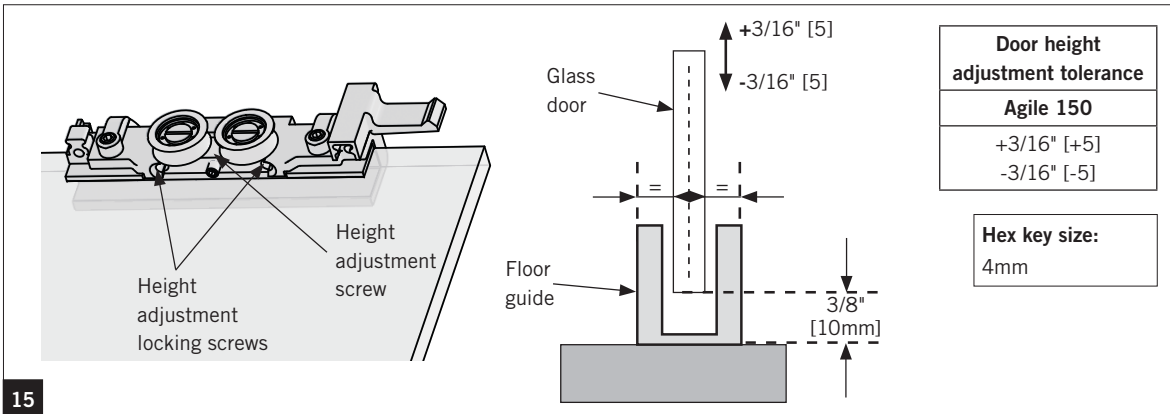

15

- 15.1 Loosen height adjustment locking screws.
- 15.2 Turn height adjustment screw **CLOCKWISE** or **COUNTER-CLOCKWISE** to raise or lower glass.

NOTE: Be sure glass is level during this adjustment.

Adjusting the anti-jump

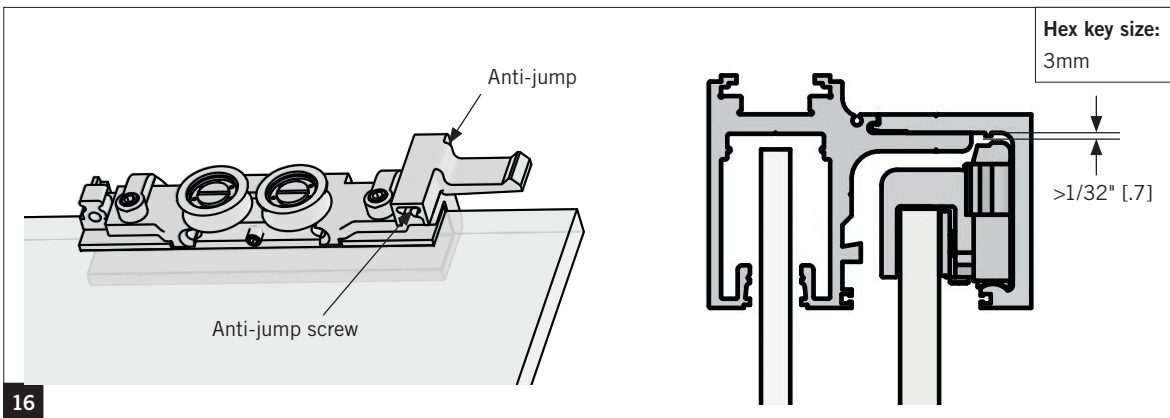

16

- 16.1 Adjust anti-jump on roller carrier.
- 16.2 Rotate anti-jump screw **CLOCKWISE** or **COUNTER-CLOCKWISE** to raise or lower anti-jump.

Install sliding door strike

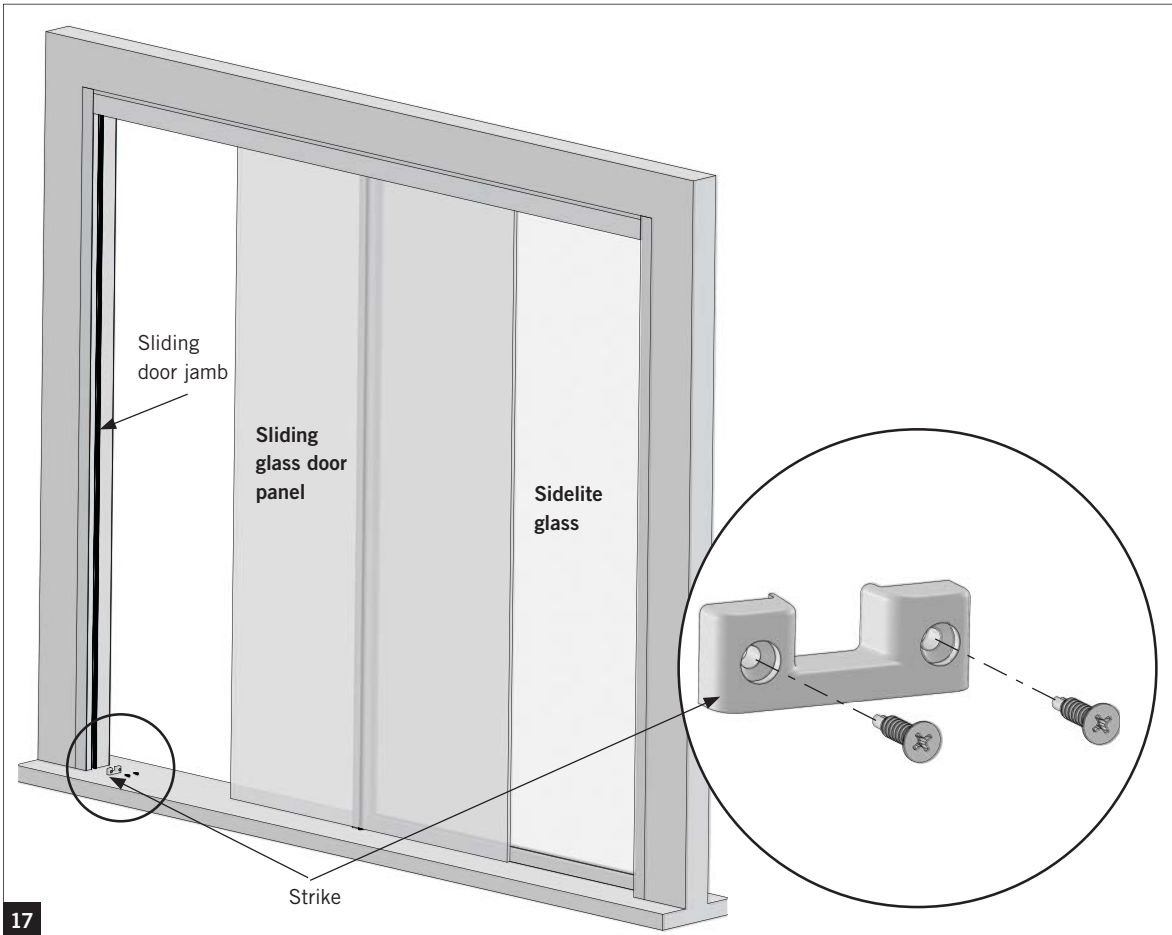

17

17.1 Secure strike into side door jamb.

- Use two screws provided.

Install track covers

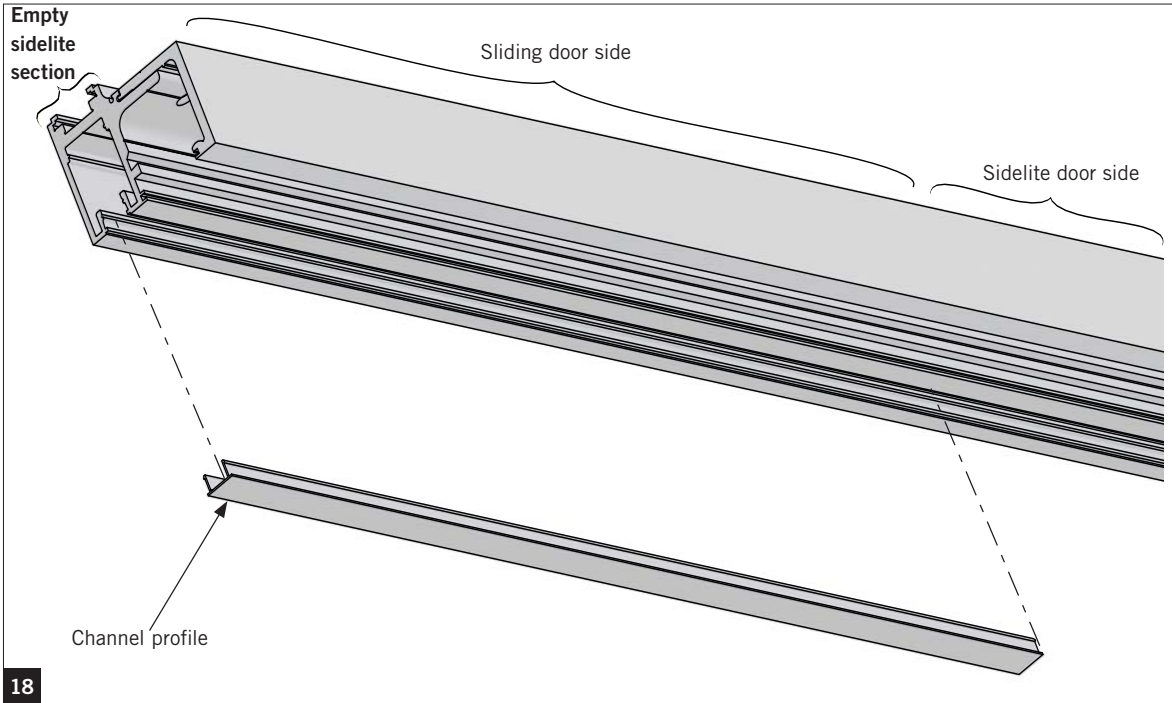

18.1 Measure and cut to proper length.

18.2 Snap into place along empty sidelite track section of header.



DORMA USA, INC.
DORMA DRIVE, DRAWER AC
REAMSTOWN, PA 17567
TOLL-FREE: 800-523-8483
FAX: 800-274-9724
WWW.DORMA.COM